

GULF 32



Builder	: Capital Yachts, USA	Year	: 1989
Designer	: William Garden	Construction	: GRP
Length	: 32 ft / 9.85 m	Engine	: Universal 32 HP
Beam	: 10 ft / 3.07 m	Max Speed	: 6.5 Knots
Draft	: 5 ft 2 in / 1.59 m	Accom.	: 6 berths
Lying	: Subic bay/Philippines	Price	: USD 70,000

GENERAL

Builder : Capital Yachts, San Francisco, USA
Designer : William Garden
Model : Gulf 32
Year : 1989
Hull Number : # CPY 00318C989
Registration : SSR United Kingdom (not tax paid)
Last Slipped : May 2006

CONSTRUCTION

Type : Aft cockpit / pilothouse sloop with twin helms
Hull/Deck Material : Hull - solid GRP laminate; deck – GRP/balsa core
Decks : Non-skid GRP
Keel : Full length encapsulated lead keel
Colour : White with blue gunwhale

DIMENSIONS

Length : 32 ft / 9.85 m
Length Waterline : 25 ft / 7.69 m
Beam : 10 ft / 3.07 m
Draft : 5 ft 2 in / 1.59 m
Displacement : 16,500 lbs (Ballast 5,000 lbs)
Fuel Capacity : 70 US gallons
Water Capacity : 70 US gallons

MACHINERY

Engine : 32 HP 4 Cyl Universal diesel with two blade prop
Speed : Max 6.5 knots
Batteries : 5 – 1 engine, 4 house
Other Electrical : Sterling 40 amp battery charger (new) 240/110 v
automatic transformer; 12v-240v
converter(new)shorepower connection; 75
amp solar panel mounted on stern arch,
Bilge system : Electric and manual
Waste : Holding tank and direct
Watermaker : Village Marine – 6 gallons p/hr (currently pickled)

STEERING

The yacht is provided with dual wheel steering positions in the cockpit and in the pilothouse as well as emergency tiller.

GALLEY

Cooker	: Galley Maid 3 burner gas stove with oven
Fridge	: Top opening fridge New compressor and plate
Other equipment	: Twin stainless steel sink with fresh water foot pump; fitted for pressurised water, rail mounted BBQ

NAVIGATION AND COMMUNICATION EQUIPMENT

Autopilot	: Raytheon ST600r Plus c/w remote control
Radar	: New Raymarine C70/Radar/chartplotter/fishfinder
Chartplotter/GPS	: Navman T5500 Colour c/w C-maps for Indian Ocean & Phuket to Singapore
Speed/ Distance	: Autohelm ST 50
Depth sounder	: Autohelm ST 50
Wind Speed/Direction	: Autohelm ST 50
VHF	: Horizon Intrepid
SSB	: SGC 2000 SSB radio plus tuner
Others	: Fluxgate compass linked to autopilot; 2 steering compasses at each station; Radio/CD Player with cockpit repeater

ACCOMMODATION

Cabins	: 1 double V-berth cabin forward
Berth	: 6 + Saloon table convertible to double
Headroom	: Excellent headroom throughout
Heads	: 1 with shower

SAFETY EQUIPMENT

Life raft	: MD2 6 man with stainless steel deck mount
Lifebuys	: Lifesling Man Overboard rescue system
Life Jackets	: 4 Lifejackets with CO2 inflaters
Flares	: Full set
Other	: 4 fire extinguishers, bosun's chair, jack lines, self-draining gas bottle locker (2 cylinders)

RIG & SAILS

Rig	: Deck-stepped single spreader masthead with alloy Spars; strong point for cutter rig if required
-----	---

Rigging	: Stainless steel wire 19 mm, Spinlock rope stoppers
Mainsail	: Fully battened main (Ullman, Australia) with 2 reefs & slab reefing led to cockpit; lazy jacks.
Headsails	: 120% roller furling genoa (UK Sails, Hong Kong); 110% roller furling jib; genaker with sock

ANCHOR & DECK GEAR

Anchor	: 35 lb CQR main with 225 ft 5/16" chain; Danforth Second with 25 ft chain & 150 nylon rode
Anchor Windlass	: Lewmar electric windlass with foot press & helm controls
Deck Winches	: 3 self-tailing; 3 others
Tender	: 2.6 metre RIB with cover
Outboard	: 5.5 HP Yamaha
Bathing Platform	: Large stainless & teak hinged platform
Davits	: Stainless steel instrument mounting arch incorporating dinghy davits
Covers etc	: Full cockpit bimini (buff) plus sail, hatch, pedestal & other covers

OTHER

The current owner is the yacht's third but a full history of ownership and maintenance is available as are equipment manuals etc. Many recent new additions including engine overhaul some 200 hours ago, new radar, Included are many spares, kitchenware, crockery, tools, charts of Thailand, Philippines, Hong Kong, Malaysia, Indonesia, etc

COMMENTS

This is a highly attractive and imaginative small cruising yacht that is admired in any marina. She seems much bigger than her overall dimensions would suggest with a spacious cockpit and open deck space. The pilothouse provides for a very airy & bright interior; the cabinetry is high quality and attractive; the saloon area is surprisingly spacious and comfortable. She can accommodate up to 6 persons on weekend trips but is also ideal as a live-aboard. She is immediately available for sale due to an unexpected change in her owner's plans and is well worthy of inspection. There is absolutely nothing to be done to this yacht, she is ready to sail anywhere in the world. Subic bay in the Philippines is an ideal location as it's a 1 hour drive from Clark int airport to the yacht club.



Saloon - Port



Saloon - Stb



Galley



Nav Station



Forward Cabin



Head



Quarter Berth



Pilothouse Helm



Engine



Entrance



On the Hard



Stern Platform

Gulf-32

SPECIFICATIONS

L.O.A. 32'
 L.W.L. 25'
 BEAM 10'
 DRAFT 5'2"
 SHOAL DRAFT 4'6"
 Displacement Sailaway:
 Approx. 15,000 lbs.
 Hull Fiberglass
 Spars Aluminum
 Sail Area w/styl. 555 sq. ft.
 J 12'2 1/2"
 I 38'
 P 33'
 E 12'7"
 Some items shown are optional.

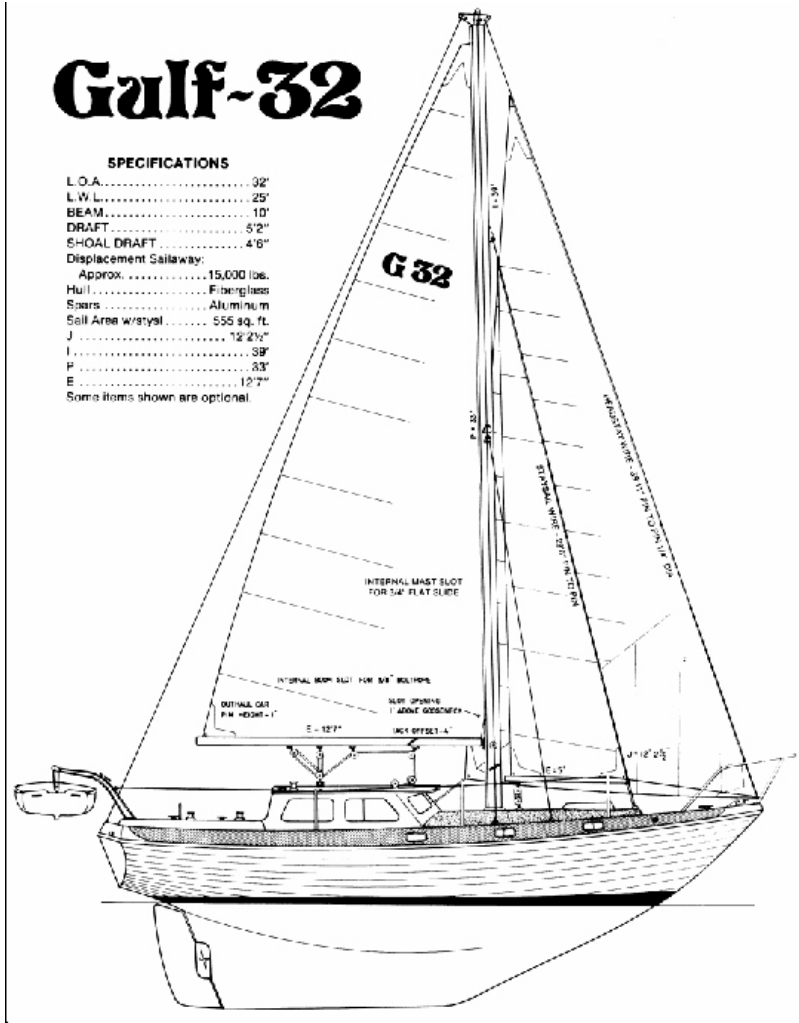

Sail Plan (not exact)

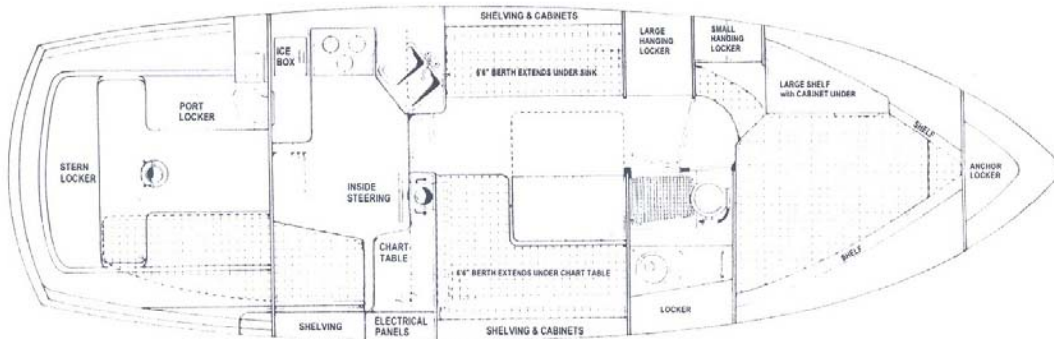

Layout